

DUST CONTROL

SPECSHEET

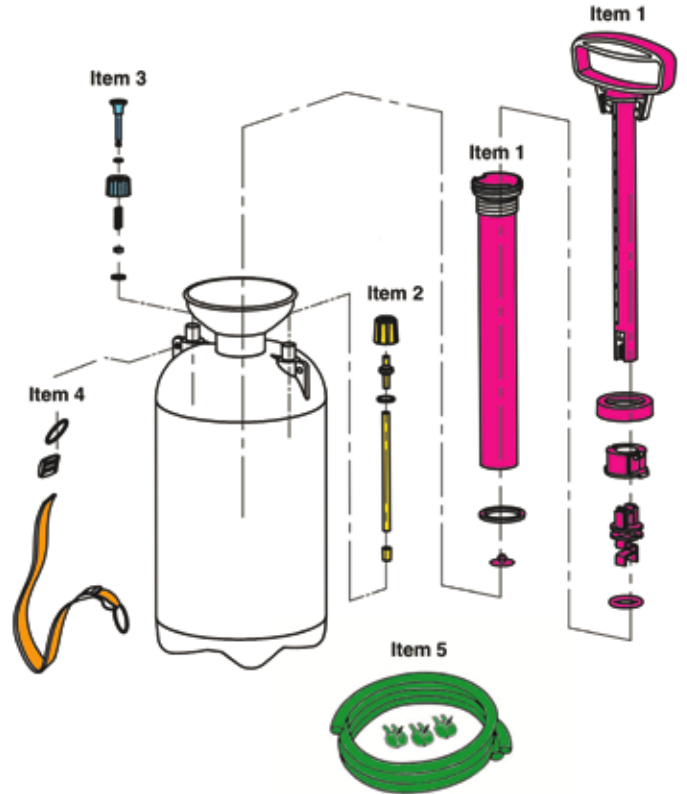

PRODUCT DETAILS:

Part No.	Dimensions
MC10985	16 litre Dust Control Tank
MC10986	*Service Kit
MC10987	Replacement hose c/w fittings
MC10984	Pressure Valve
MC10987A	Replacement Hose Spring
MC10984	Replacement pump and handle assembly

*Comprises:

- 1) Pump and handle. 2) Internal pick up hose connection. 3) Safety pressure release. 4) Carry strap

- Item 1: Pump and handle assembly (MC10987B)
 - Item 2: *Internal pick up hose and external hose connection
 - Item 3: Safety pressure release (MC10984)
 - Item 4: *Carry strap
 - Item 5: External hose with fittings (MC10987)
- *Items 1, 2, 3 & 4 come already assembled

DESCRIPTION: Whilst using a petrol disc cutter to cut concrete and other masonry materials, the dust created causes a multitude of problems, from a nuisance to passing members of the public to the far more serious issue of air borne dust that contains respirable crystalline silica (RCS) - This is a serious health hazard and is being closely monitored by the HSE, who have produced a leaflet titled 'dust control on cut off saws used for stone or concrete cutting' (construction sheet 54). PDP's dust control tank can help limit the RCS becoming air borne during cutting, reducing the risk of inhaling the RCS dust.

MACHINE SUITABILITY: Hand held cut off saws, diamond drilling rigs and handheld wet drilling

FEATURES:

- Dust control for hand held petrol disc cutters.
- Heavy-duty polyethylene body.
- Universa fitting for easy connection to Stihl, Husqvarna, Makita and other popular makes of petrol cut off saws.
- 16 litre capacity.
- 3 metre Flexible hose.

PACKAGING DETAILS:

Full colour corrugated cardboard box

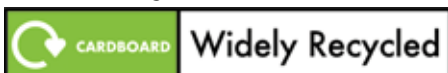

E sales@premierdiamondproducts.co.uk T +44 (0) 1227 711 555

DUST CONTROL

DUST CONTROL TANK INFORMATION:

- The following is stated by the HSE on their leaflet titled 'Dust control on cut off saws used for stone or Concrete cutting' (construction information sheet No. 54): "Even with the use of water suppression or extraction, suitable respiratory protective equipment (RPE) with the assigned protection factor of at least 20 will still be needed, for example either FFP3 filtering face-pieces or orinasal respirators with P3 filters... Nuisance-grade dust masks DO NOT protect your lungs"
- When using the PDP Dust Control Tank connected to a petrol disc cutter, in order to achieve the optimum flow rate of 0.5L per minute pump the handle 20 times and then maintain the pressure throughout usage with additional pumps of the handle.
- The PDP Dust Control Tank can also be used as a secondary option to a direct hose pipe feed when using wet core drilling machines. The 0.5L flow rate of water does not apply when using the Dust Control Tank with machines of this nature. A general rule of thumb is to have as higher flow rate as possible to aid the wet drilling core to remain cool during this application.
- Over pressurising of the tank (excessive pumping of the handle) can result in the safety pressure release valve